

PACKAGE CONTENTS

PART	DESCRIPTION	QTY
A	Fixture	1
B	Mounting bracket	1
C	Electrical box screws	2
D	Wire connectors	3

BEFORE YOU BEGIN

WARNING

Make sure power is **OFF** at the electrical panel before starting installation or any maintenance. Indoor installation only unless otherwise noted.

SAFETY

This fixture must be wired in accordance with local electrical codes and ordinances. All work should be done by a qualified electrician.

NOTE

Read all instructions before installing. Keep this sheet for future reference.

INSTALLATION

- 01 Shut off power at the electrical panel before beginning.
- 02 Choose your CCT before mounting. Factory setting: 2700K.
- 03 Feed ground, black, and white supply wires through the mounting bracket (B). (FIG. 1)
- 04 Make electrical connections using wire connectors (D): black-to-black, white-to-white, ground-to-ground.
- 05 Fasten the mounting bracket to the electrical box with screws (C).
- 06 Tuck wires inside the electrical box.
- 07 Snap the fixture (A) into the mounting bracket — confirm the fixture is fully seated. (FIG. 2)
- 08 Restore power.

FIGURES

FIG. 1

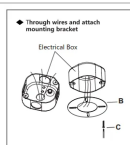

Fig. 1 · Bracket on electrical box

FIG. 2

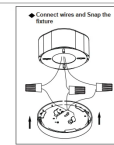

Fig. 2 · Snap-in fixture detail